

## vital™ Cluster Box Unit - Type IV

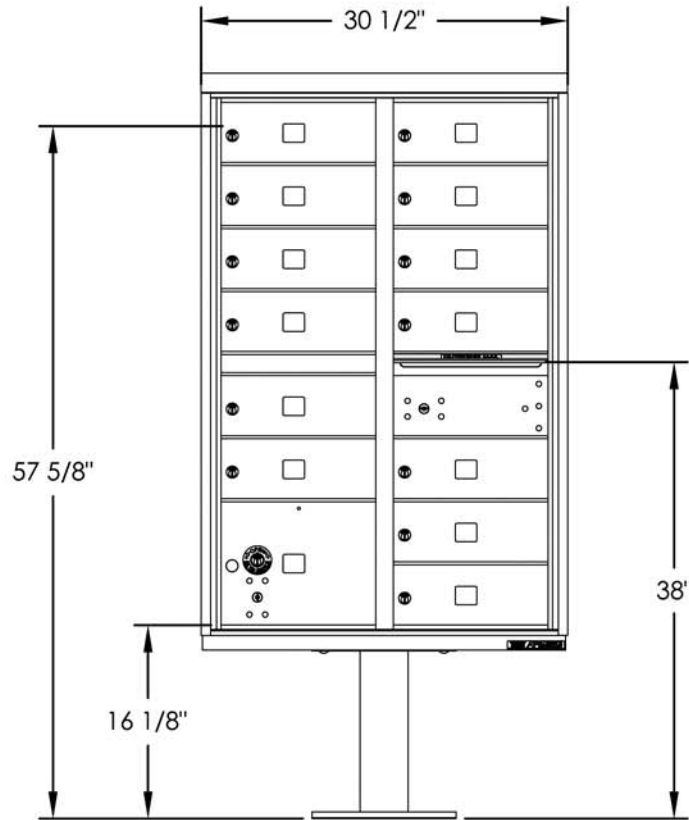

FRONT VIEW

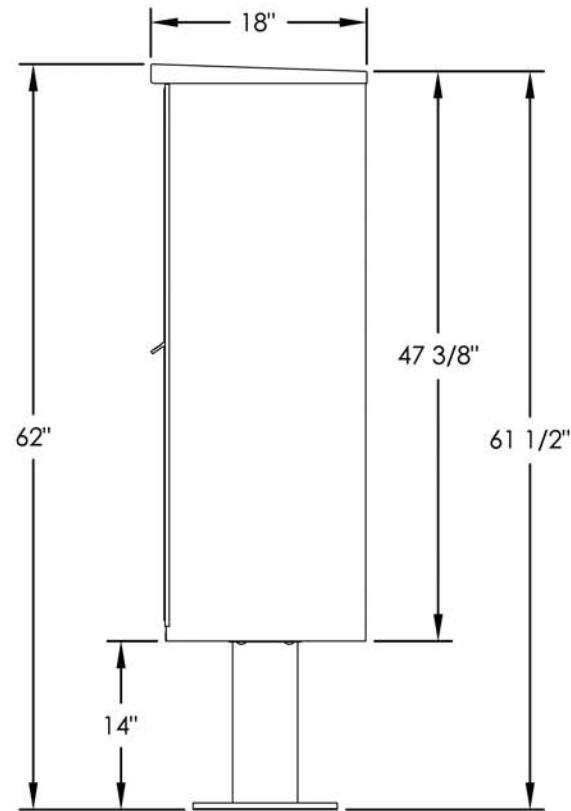

SIDE VIEW

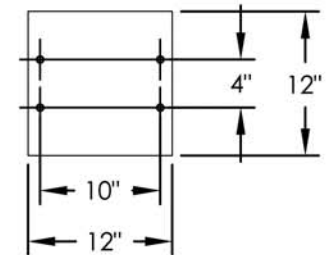
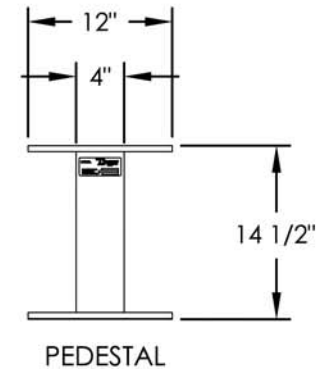

DOOR CHART

DOOR TYPE	DIMENSION (HEIGHT x WIDTH)
TENANT	5" x 12-13/16"
10" PARCEL	10-1/4" x 12-13/16"
OUTGOING SLOT	3/4" x 11-3/4"

### NOTES:

1. This unit is approved for USPS and private applications.
2. Decorative mailbox accessories sold separately and are USPS Approved products.
3. CBU pedestal should be installed with included Rubber Pad; mounting hardware not included, refer to installation manual for recommendation.
4. Florence "F" series CBU is Officially Licensed by USPS.  
License#CDSEQ-08-B-0012

PRODUCT SERIES:

vital™ CLUSTER BOX UNIT



**NATIONALMAILBOXES**

A DIVISION OF NMHP INC.  
North America's Commercial & Residential Mailbox Leader!

Address: P.O. Box 13144, Wauwatosa, WI 53213  
Phone Number: 1-800-676-5161  
Website: [www.NationalMailboxes.com](http://www.NationalMailboxes.com)

MODEL 1570-13	REV A
SCALE NONE	LAST REV DATE 9/26/2012
DRAWING NUMBER 1570-13CS	DRAWN BY AFD