

versatile™ 4C Surface Mount Collar, SM15D

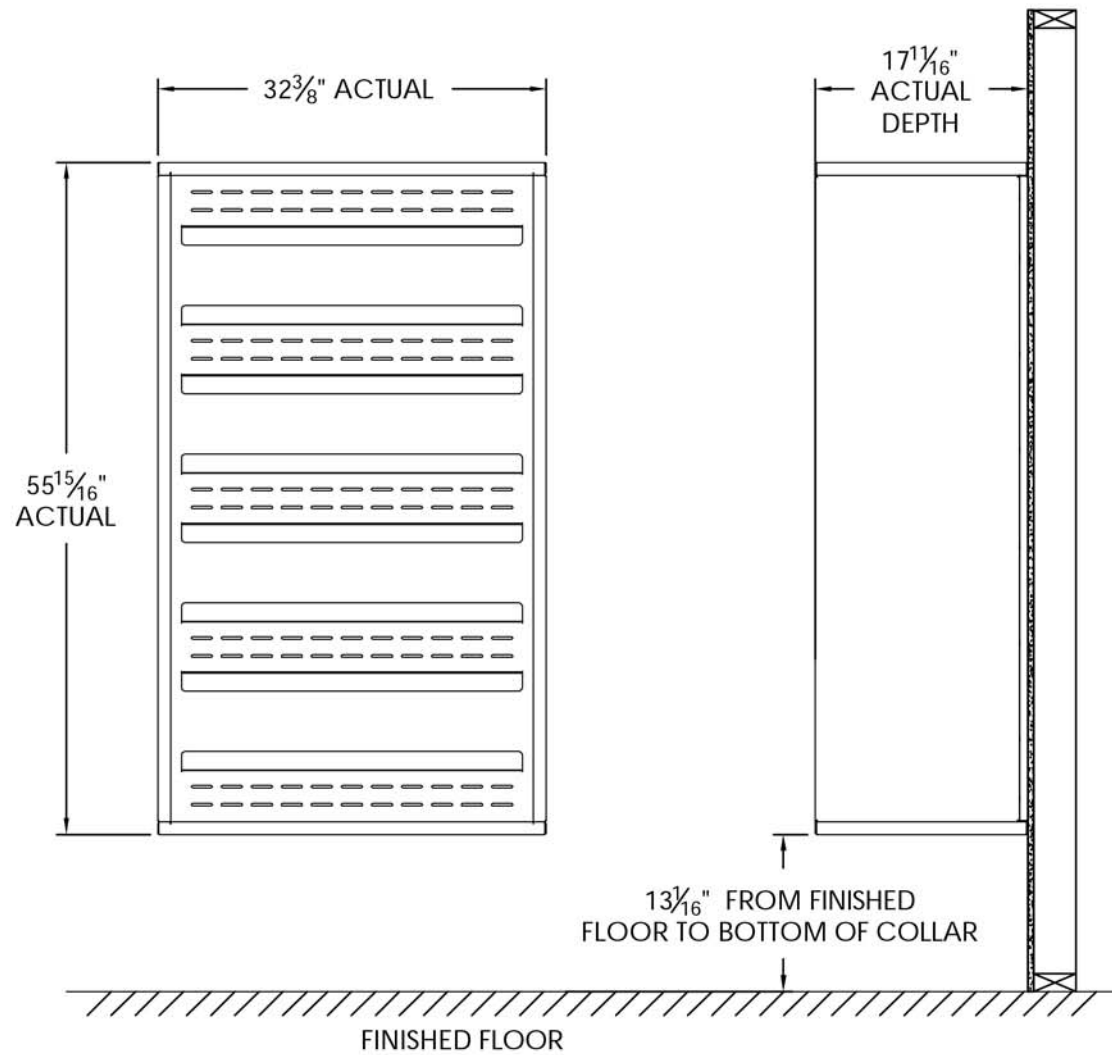

Notes:

1. Designed to mount Florence Versatile™ 4C mailbox double column 15-High Suite modules (sold separately).
2. For use with front loading modules only.

PRODUCT SERIES: VERSATILE™ 4C SURFACE MOUNT COLLAR



NATIONALMAILBOXES
A DIVISION OF NMHP INC.

North America's Commercial & Residential Mailbox Leader!

Address: P.O. Box 13144, Wauwatosa, WI 53213
Phone Number: 1-800-676-5161
Website: www.NationalMailboxes.com

| | | | |
|----------------|---------|---------------|------------|
| MODEL | SM15D | REV | B |
| SCALE | NONE | LAST REV DATE | 07/02/2014 |
| DRAWING NUMBER | SM15DCS | DRAWN BY | TNS |